

1. Add mounting plates for adjusting the push rod to be perpendicular if needed.
2. Adjust the linkage ball with aluminum sheath as illustrated.

1. 可增加伺服器固定片調整伺服器拉桿為垂直。
2. 調整球頭延伸長度使伺服器拉桿為垂直。

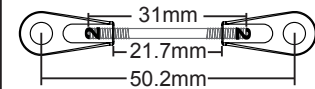

Use No.2 ball link. Adjust the push rod length according to the servos you use.
使用2號伺服器拉桿頭。
各廠牌伺服器不同請依需求配置。

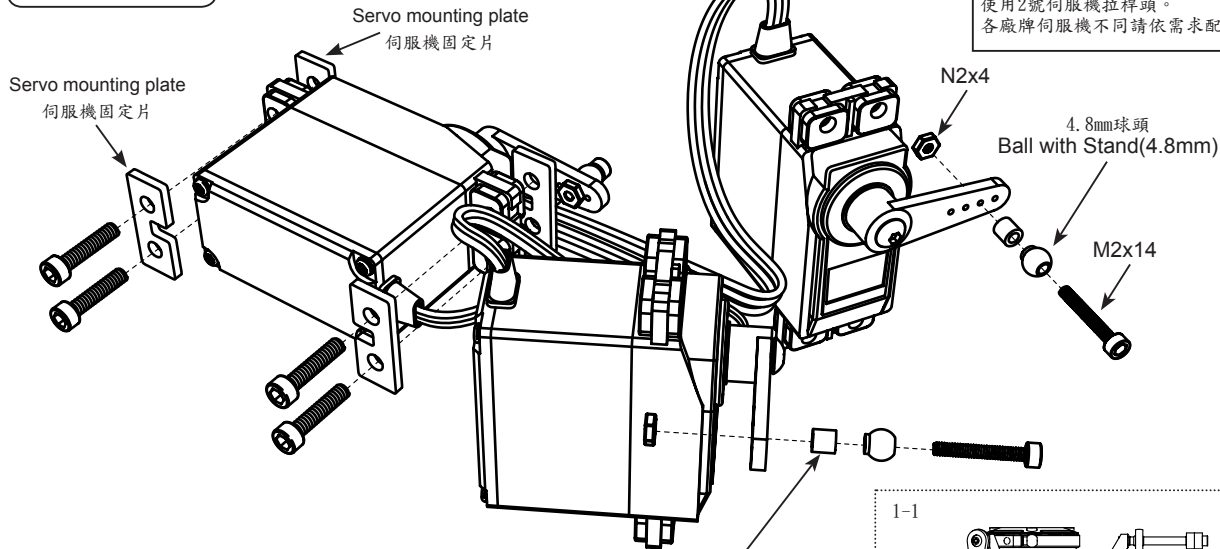

調整用鋁套:
Adjusting aluminum sheath.
P2x3.5x1.5
P2x3.5x2.5
P2x3.5x3.5

1. After assembling 3 sets of servo push rod with No.2 ball links, confirm if the push rods are perpendicular as illustrated.
2. If not, you need to adjust it with aluminum sheaths or adjust the servo mount as illustrated in .

1. 使用2號CCPM拉桿頭製作3支拉桿並在後續組裝時扣上伺服器，確認拉桿是否為垂直(1-1)。
2. 如有偏移情況請適當增加球頭延伸長度或調整伺服器座位置使拉桿為垂直。

